

N.B. This survey is disputed by Henry Baugher

Courses and distances up French Creek beginning at a Beech

- N 19° 14' E 10.8
- N. 10 1/2 E 14.1
- N. 2 1/2 E 12.
- N 17 1/4 W 5.8
- N 28° W 10.
- N 45° W 17.
- N 35° W 50.
- N 30 3/4 W 8.
- N 25° W 12.1
- N 11° W 10.
- N 5° W 10.6
- N 15° E 21.

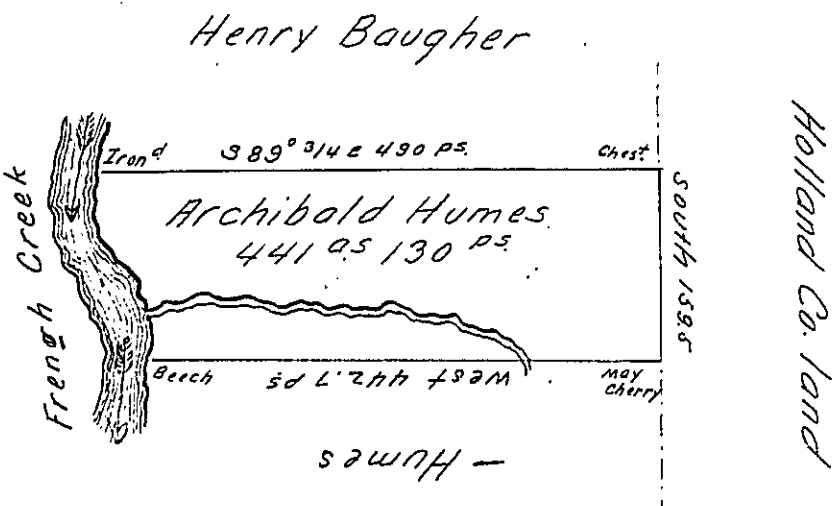

In pursuance of a Warrant for 400 acres of Land dated the 13<sup>th</sup> day of August 1801. was surveyed the 28<sup>th</sup> day of May 1802. for Archibald Humes the above described Tract of Land containing 441 Acres 130 perches and allowance of Six per Cent for Roads &c. Situate in Rockdale Township Crawford County.

To Samuel Cochran Esquire      William M<sup>c</sup> Arthur D.S.  
 Surveyor General

IN TESTIMONY that the above is a copy of the original remaining on file in the Department of Internal Affairs of Pennsylvania, made conformably to an Act of Assembly approved the 16th day of February, 1833, I have hereunto set my Hand and caused the Seal of said Department to be affixed at Harrisburg, this sixth day of February 1905.

*Anna B. Brown*  
 Secretary of Internal Affairs.